

# Board Report

September 28, 2015



# Project schedule

School	Concept / SD	Bid	Intended Occupancy
Anderson	8/15/2015	Feb-16	7/20/2018
Turpin	6/17/2015	Jan-16	7/20/2018
Nagel	3/31/2015	7/22/2015	1/4/2016
Nagel Site Package	3/31/2015	Oct-15	7/22/2016
Ayer	3/20/2015	7/22/2015	7/21/2017
Ayer Summer 2015 Ramp Package		5/26/2015	10/28/2015
Maddux	7/15/2015	Jan-16	7/21/2017
Mercer	7/15/2015	Dec-15	7/21/2017
Sherwood	3/20/2015	7/22/2015	7/21/2017
Sherwood Summer 2015 Ramp Pkg		5/26/2015	10/28/2015
Summit	6/19/2015	Oct-15	7/21/2017
Wilson	6/19/2015	Nov-15	7/21/2017



- Phase complete



- Ready to Bid



- Currently Bidding



- Currently Under Construction

# Projects Ready for Bidding

## Bids 10-15-2015

Nagel Middle School Site Package

Summit Elementary



# Next Project(s) Bidding

Nagel Middle School – Site Package



# Bid Pack

## Nagel Site

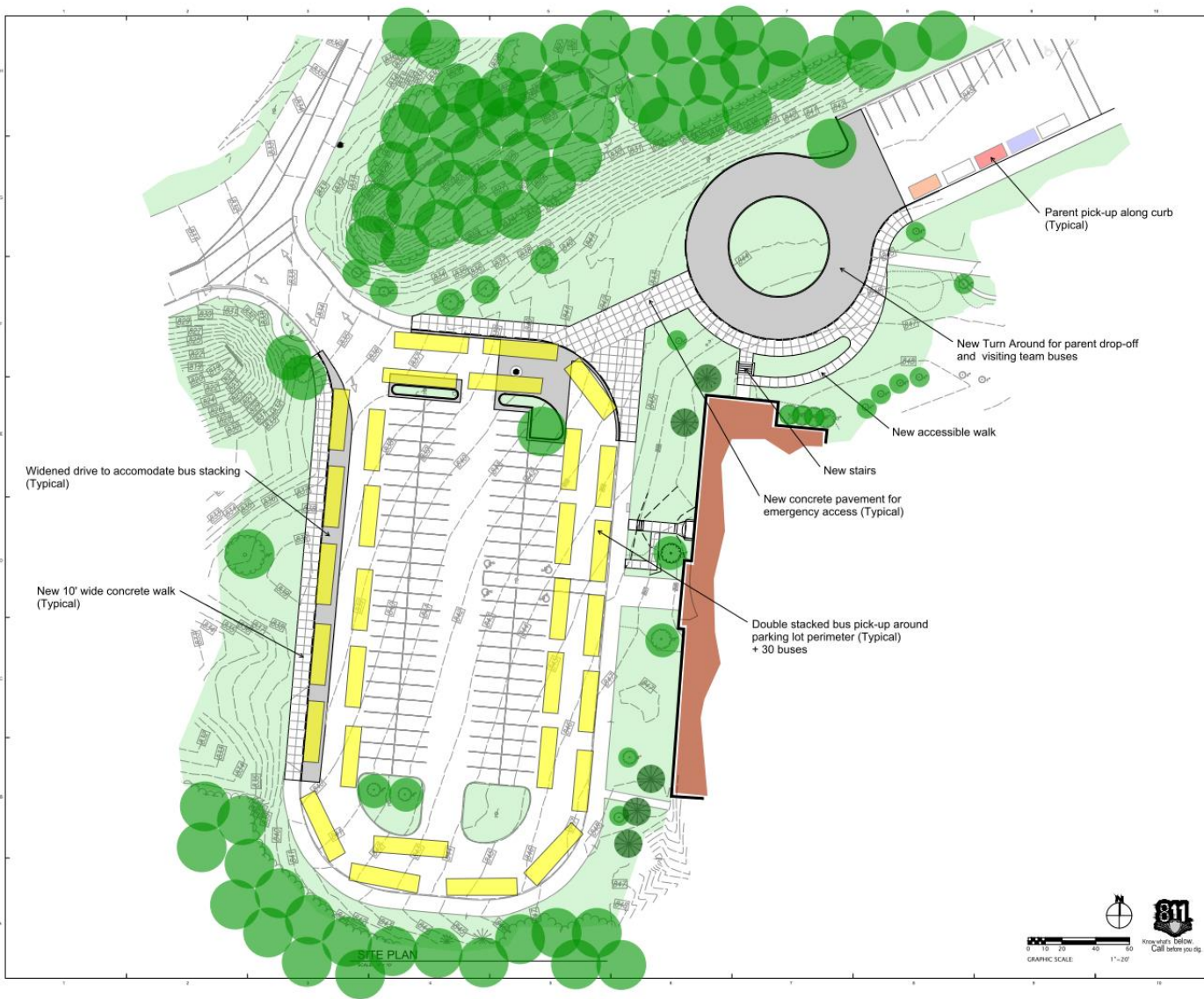

**SSOE**

---

**Motz Engineering**  
100 West 43rd Street, Suite 100  
 Cincinnati, Ohio 45225

---

SEAL OF THE DOCUMENT AUTHORIZED BY:

---

SEAL NO., FIRM NAME AND LICENSE NUMBER DATE:

**PROJECT INFORMATION**

**Nagel Middle School**  
 7550 Forest Road  
 Cincinnati, Ohio  
 45255

---

CLIENT INFORMATION:

**Forest Hills School District**  
 1500 Nagel Road  
 Cincinnati, Ohio  
 45225

CLIENT PROJECT NO. 000-00000-00

NO. OF SHEETS	11
DATE	
DRAWN	
CHECKED	
APPROVED	
PROJECT NO.	015-00480-00
PROJECT DESCRIPTION	CONSTRUCTION
DISCIPLINE	LANDSCAPE ARCHITECTURE
DATE	
DRAWN BY	
CHECKED BY	
DATE	
PROJECT NO.	015-00480-00
PROJECT DESCRIPTION	CONSTRUCTION
DISCIPLINE	LANDSCAPE ARCHITECTURE
DATE	
DRAWN BY	
CHECKED BY	
DATE	
PROJECT NO.	015-00480-00
PROJECT DESCRIPTION	CONSTRUCTION
DISCIPLINE	LANDSCAPE ARCHITECTURE
DATE	
DRAWN BY	
CHECKED BY	
DATE	
PROJECT NO.	015-00480-00
PROJECT DESCRIPTION	CONSTRUCTION
DISCIPLINE	LANDSCAPE ARCHITECTURE
DATE	
DRAWN BY	
CHECKED BY	
DATE	

**SITE PLAN**

---

DRAWN BY  
**C-100**

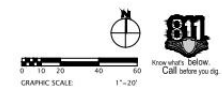

**SITE PLAN**

# Next Project(s) Bidding

Summit Elementary School –  
Additions and Renovations



# Bid Pack

## Summit Elementary Additions and Renovations

